

# CR 1000 & CR 1250 Water Coolers

**Lightweight and User-friendly cooling units with integrated flow switch for reliable performance.**

**For Manual & Robotic MIG Guns and TIG Torches.**



CR 1250

ABICOR  
BINZEL 

ABICOR  
BINZEL 

[www.binzel-abicor.com](http://www.binzel-abicor.com)

# Water-Coolers

## CR 1000, CR 1250 (115 V)



Splash-proof fuse and power switch

Integrated flow control switch as standard

International water quick connectors

Transparent tank for visible coolant level and easy fill and drain



### Water-cooler Accessories

Description	Part No.
MIG Water hose install /extension kit (10 ft)	BWC-029
MIG Water hose install /extension kit (30 ft)	BWC-028
TIG Water install kit (10 ft)	284.0609
ABI-Cool LC coolant (1 gal)	192.0232
ABI-Cool ECO coolant (1 gal)	192.9022

### Technical data: (EN 60 974-7)

#### CR 1000 (P/N 850.1002)

IP Rating	23
Tank contents	1.59 Gal (6 L)
Max cooling	up to 1000 W *Binzel torches up to 300A
Capacity	7.4 qt/min (7 L/min)
Radiator	2 - Row
Dimensions	Length: 19.3" (490 mm) Width: 9.8" (250 mm) High: 16" (410 mm)
Weight	32.85 lbs (14.9 kg)

#### CR 1250 (P/N 850.1052)

IP Rating	23
Tank contents	1.59 Gal (6 L)
Max cooling capacity	up to 1250 W *Binzel torches up to 600A
Radiator	7.4 qt/min (7 L/min) 3 - Row
Dimensions	Length: 27.2" (690 mm) Width: 9.8" (250 mm) High: 13.4" (340 mm)
Weight	36.82 lbs (16.7 kg)

\*Actual rating varies based on many factors.

### ABI-Cool LC coolant

- Year-round protection for water-coolers
- Lubricates pump and prolongs seals and shaft life
- Protects from freezing to - 32° F
- Should be changed annually to maintain maximum protection and lubrication



### ABI-Cool ECO coolant

- Year-round protection for water-coolers
- Non-regulated, non-hazardous propylene glycol base
- Protects from freezing to 10° F
- Should be changed annually to maintain maximum protection and lubrication



# Water-Coolers

## CR 1000 – Spare Parts

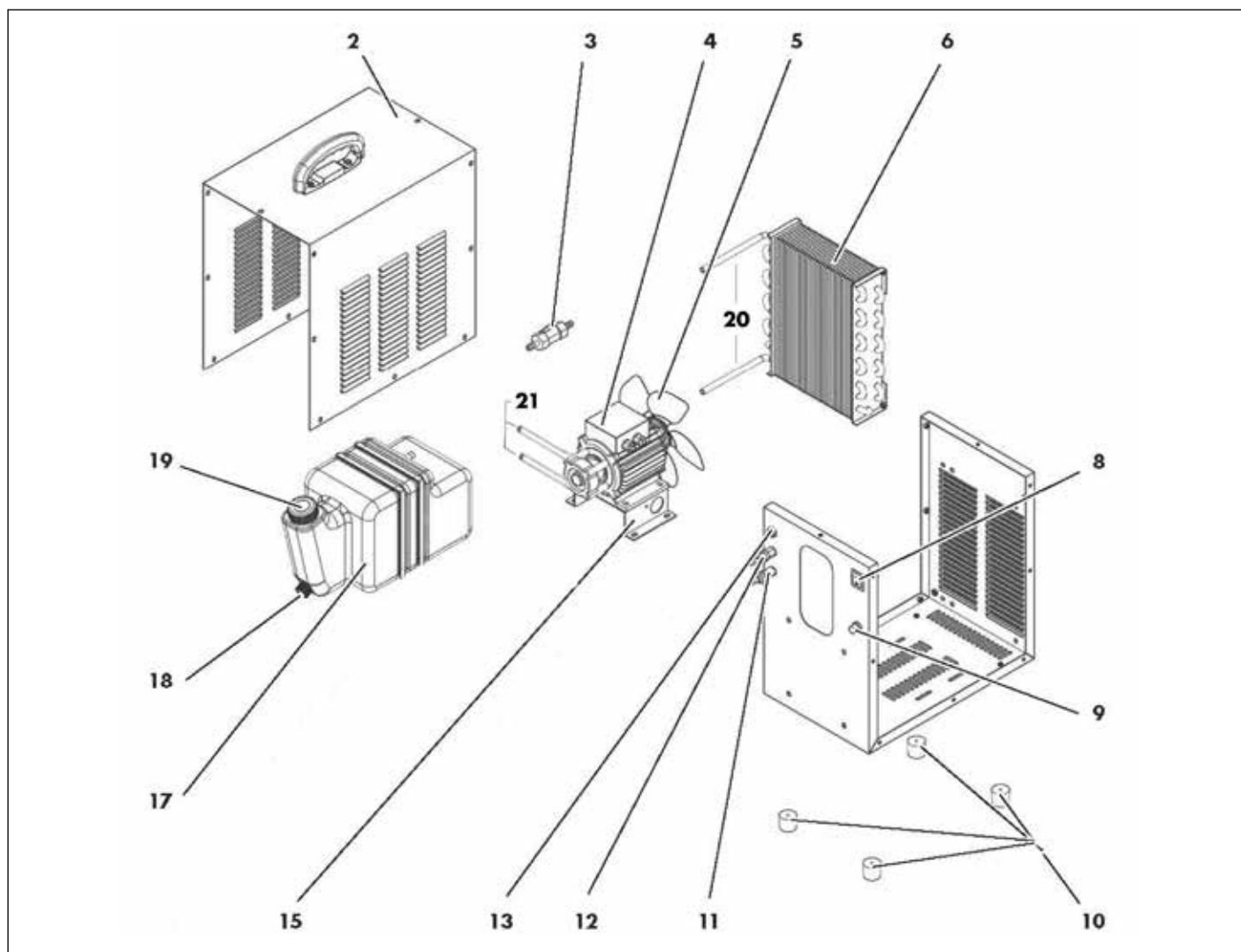

Pos No.	Description	Part No.
2	Chassis hood	850.1003
3	Flow switch	850.1059
4	Motor/pump complete w/fan	850.1017
5	Fan complete	850.1020
6	Radiator 2-row	850.1004
8	Power switch	850.1007
9	Fuse assembly w/holder	850.1018
10	Rubber feet 4 pk	850.1019
11	Quick coupler female red	850.1011
12	Quick coupler female blue	850.1012

Pos No.	Description	Part No.
13	Control socket female 2-pole	850.1060
15	Motor mount	850.1015
17	Water tank	850.1008
18	Drain cap and seal	850.1014
19	Tank fill cap	850.1013
20	Hose to and from radiator	109.9013
21	Kit replacement hose assembly for CR series coolers	284.1413
N/S	Water hose kit 2m w/10 clamps	850.1022
N/S	Fuse 5A	850.1025
N/S	Flow switch control lead w/plug	850.1026



# Water-Coolers

## CR 1250 – Spare Parts

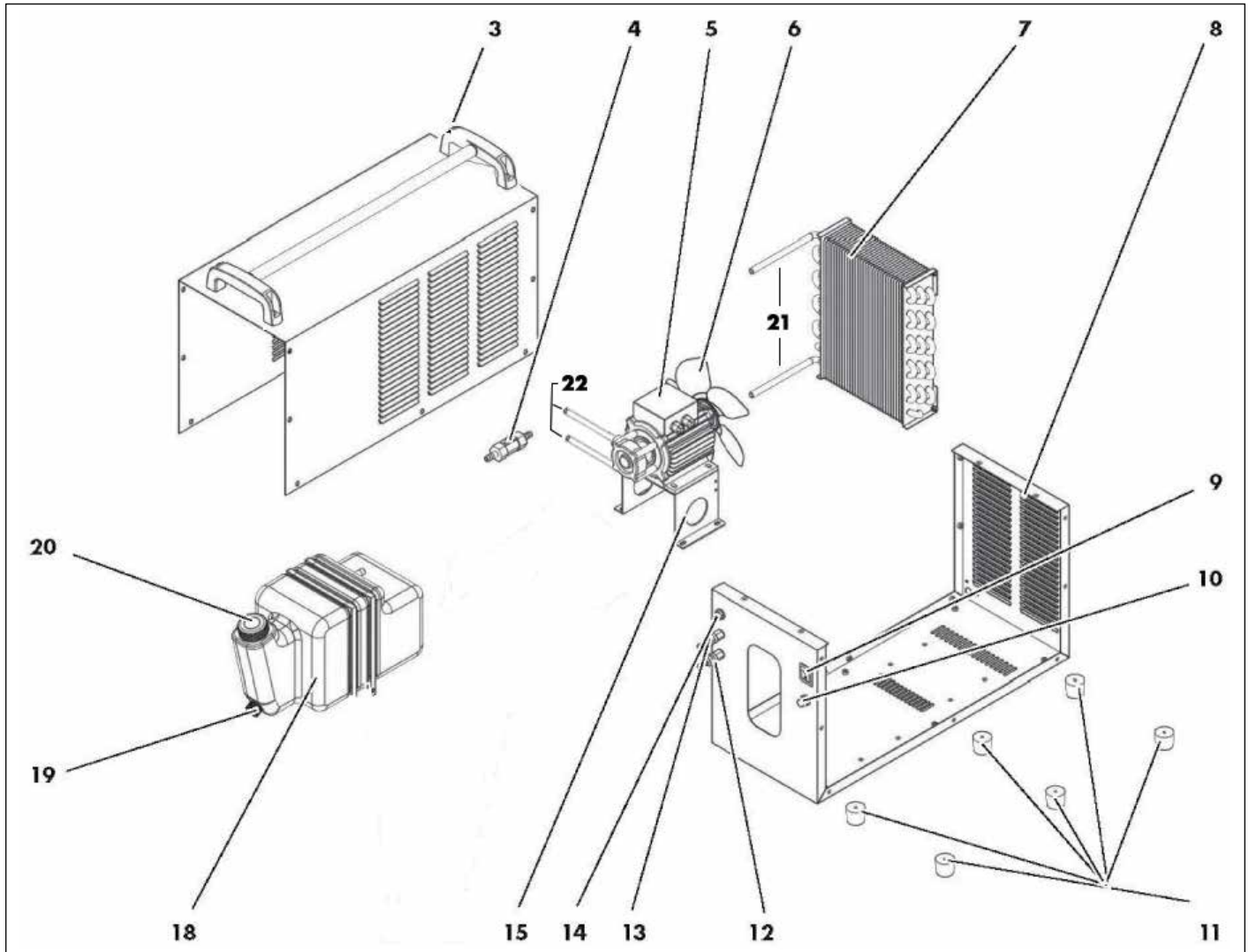

Pos No.	Description	Part No.	Pos No.	Description	Part No.
3	Chassis hood	850.1053	14	Control socket female 2-pole	850.1060
4	Flow switch	850.1059	15	Motor mount	850.1058
5	Motor/pump complete w/fan	850.1017	18	Water tank	850.1008
6	Fan complete	850.1020	19	Tank drain cap and seal	850.1014
7	Radiator 3-row	850.1054	20	Tank fill cap	850.1013
8	Chassis bottom	850.1055	21	Hose to and from radiator	109.9013
9	Power switch	850.1056	22	Kit replacement hose assemblies for CR series coolers	284.1413
10	Fuse assembly w/holder	850.1018	N/S	Water hose kit 2m w/10 clamps	850.1022
11	Rubber feet 4 pk	850.1019	N/S	Fuse 5A	850.1025
12	Quick coupler female red	850.1011	N/S	Flow switch control lead w/plug	850.1026
13	Quick coupler female blue	850.1012			



Binzel S.A DE C.V.  
 Municipio Pabellon de Arteaga 102  
 Valle De Aguascalientes, 20358  
 San Francisco de los Romo, Ags. Mexico  
 Phone: +52(499) 973.0133  
 Fax: +52(499) 973.1388  
 E-Mail: info@binzel.com.mx

ABICOR BINZEL USA, Inc.  
 650 Medimmune Court, Suite 110  
 Frederick, MD 21703  
 Phone: 800.542.4867  
 Fax: 301.846.4497  
 E-Mail: customerservice@abicorusa.com

[www.binzel-abicor.com](http://www.binzel-abicor.com)